







Basemap : OS 1:5000 OSI Rural Place map  
 OS Licence No : CYAL50173281  
 Date of Purchase : 22/02/2021  
 © Ordnance Survey Ireland  
 Coordinate projection: ITM EPSG : 2157  
 Easting & Northing

**LEGEND**

Fibre Route-Site Boundary	
Eir Fibre Route (35x8.5m Poles)	
Special Protection Areas (SPA)	
Water feature	
SMRs	
Electric MV/LV Overhead	

**Notes:**  
 Approx. Route Length  
 2.90Km  
 Poles are to be erected at 50 metre intervals along the road in locations where no existing poles exist today

Project Description  
**Caher Cross to Cloonagh Section 5**  
 Fibre Route augmentation

Project No.: <b>05-802</b>	Sheet No.: <b>DR-002</b>
-------------------------------	-----------------------------

Scale <b>1:2500</b>	Page Info <b>A3</b>	Date <b>18/01/2022</b>
------------------------	------------------------	---------------------------

Title  
**Site Designations Map**







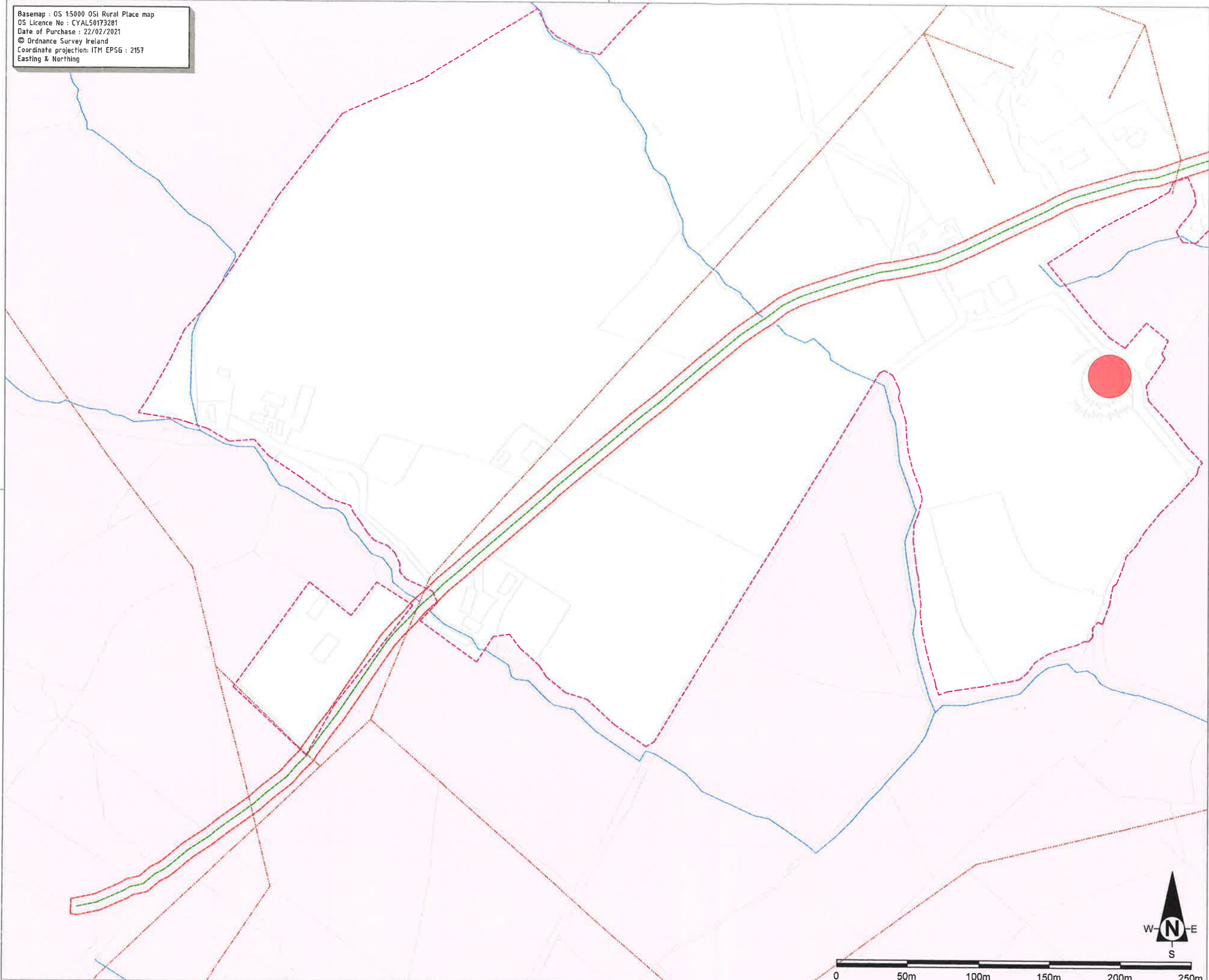

Drawings Prepared by : Yogi Murthi  
 Drawings Verified & Approved by : Kieran Tarpey  
 Entrust Ltd,  
 Unit 1D Deerpark Business Centre  
 Oranmore, County Galway, H91 X599  
 Email : [contact@entrust-services.com](mailto:contact@entrust-services.com)  
 Phone : +353 (0) 91 342 511

Disclaimer : Information on this map is reproduced from digital and other material from different sources. Minor discrepancies may therefore occur. This plan should be used for identification purpose only, unless specifically stated above or in accompanying documentation. Entrust takes no responsibility for the accuracy of data provided by third parties.



Basemap : OS 1:5000 OSI Rural Place map  
 OS Licence No : CYAL50173281  
 Date of Purchase : 22/02/2021  
 © Ordnance Survey Ireland  
 Coordinate projection: ITM EPSG : 2157  
 Easting & Northing

**LEGEND**

- Fibre Route-Site Boundary 
- National Heritage Area (NHA) 
- Special Protection Areas (SPA) 
- Water feature 
- SMRs 
- Electric MV/LV Overhead 
- Electric MV/LV Underground 

**Notes:**  
 Approx. Route Length  
 2.90Km  
 Poles are to be erected at 50 metre intervals along the road in locations where no existing poles exist today

Project Description  
**Caher Cross to Cloonagh Section 5**  
 Fibre Route augmentation

Project No.: <b>05-802</b>	Sheet No.: <b>DR-003</b>
Scale <b>1:2500</b>	Page Info <b>A3</b>
Date <b>18/01/2022</b>	

Title  
**Site Designations Map**

**entrust**  
 planning & environmental



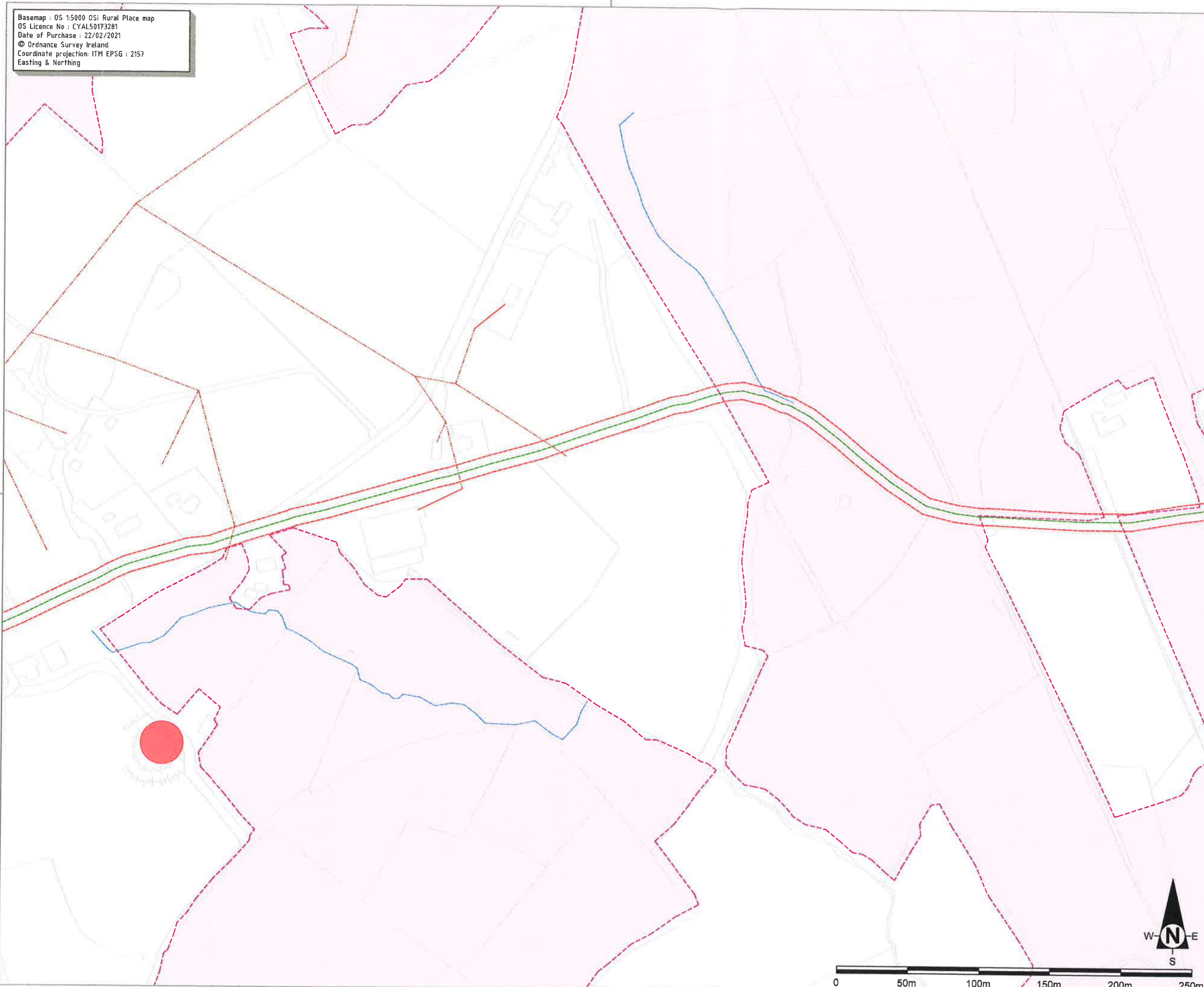

Drawings Prepared by : Yogi Murthi  
 Drawings Verified & Approved by : Kieran Tarpey  
 Entrust Ltd,  
 Unit 1D Deerpark Business Centre  
 Oranmore, County Galway, H91 X599  
 Email : [contact@entrust-services.com](mailto:contact@entrust-services.com)  
 Phone : +353 (0) 91 342 511

Disclaimer : Information on this map is reproduced from digital and other material from different sources. Minor discrepancies may therefore occur. This plan should be used for identification purpose only, unless specifically stated above or in accompanying documentation. Entrust takes no responsibility for the accuracy of data provided by third parties.



Basemap : OS 1:5000 OSI Rural Place map  
OS Licence No : CYALS0173281  
Date of Purchase : 22/02/2021  
© Ordnance Survey Ireland  
Coordinate projection: ITM EPSG : 2157  
Easting & Northing

**LEGEND**

Fibre Route-Site Boundary	
Eir Fibre Route (35x8.5m Poles)	
Special Protection Areas (SPA)	
Water feature	
Electric MV/LV Overhead	

**Notes:**  
Approx. Route Length  
2.90Km  
Poles are to be erected at 50 metre intervals along the road in locations where no existing poles exist today

Project Description  
**Caher Cross to Cloonagh Section 5**  
Fibre Route augmentation

Project No.: <b>05-802</b>	Sheet No.: <b>DR-004</b>
-------------------------------	-----------------------------

Scale <b>1:2500</b>	Page Info <b>A3</b>	Date <b>18/01/2022</b>
------------------------	------------------------	---------------------------

Title  
**Site Designations Map**







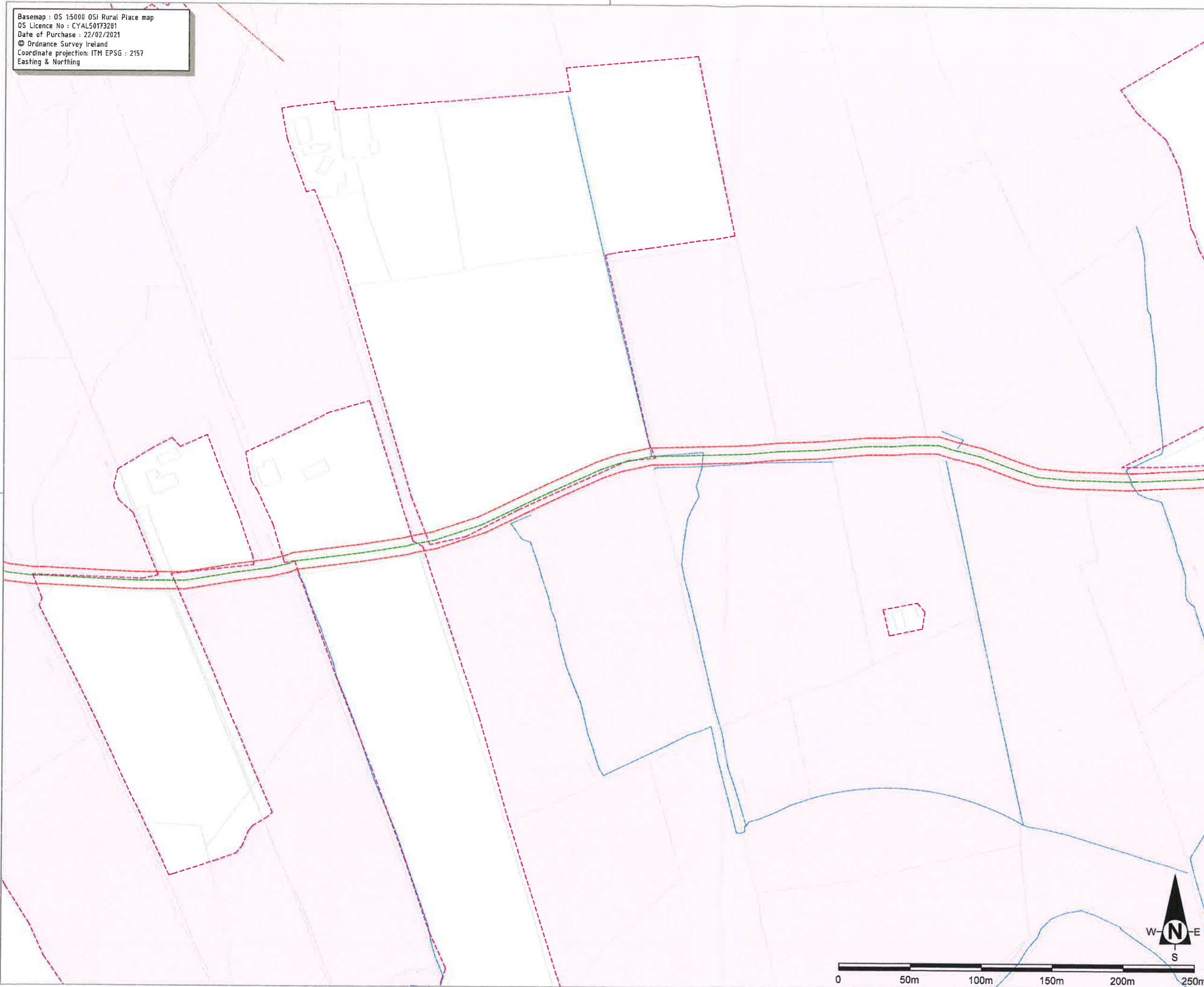

Drawings Prepared by : Yogi Murthi  
Drawings Verified & Approved by : Kieran Tarpey  
Entrust Ltd,  
Unit 1D Deerpark Business Centre  
Oranmore, County Galway, H91 X599  
Email : [contact@entrust-services.com](mailto:contact@entrust-services.com)  
Phone : +353 (0) 91 342 511

Disclaimer : Information on this map is reproduced from digital and other material from different sources. Minor discrepancies may therefore occur. This plan should be used for identification purpose only, unless specifically stated above or in accompanying documentation. Entrust takes no responsibility for the accuracy of data provided by third parties.



Basemap : OS 1:5000 OSI Rural Place map  
 OS Licence No : CYAL50173281  
 Date of Purchase : 22/02/2021  
 © Ordnance Survey Ireland  
 Coordinate projection: ITM EPSG : 2157  
 Easting & Northing

LEGEND	
Fibre Route-Site Boundary	
Eir Fibre Route (35x8.5m Poles)	
Special Protection Areas (SPA)	
Water feature	
SMRs	
Electric MV/LV Overhead	

**Notes:**  
 Approx. Route Length  
 2.90km  
 Poles are to be erected at 50 metre intervals along the road in locations where no existing poles exist today

Project Description  
**Caher Cross to Cloonagh Section 5**  
 Fibre Route augmentation

Project No.: <b>05-802</b>	Sheet No.: <b>DR-005</b>
-------------------------------	-----------------------------

Scale <b>1:2500</b>	Page Info <b>A3</b>	Date <b>18/01/2022</b>
------------------------	------------------------	---------------------------

Title  
**Site Designations Map**



Drawings Prepared by : Yogi Murthi  
 Drawings Verified & Approved by : Kieran Tarpey  
 Entrust Ltd,  
 Unit 1D Deerpark Business Centre  
 Oranmore, County Galway, H91 X599  
 Email : [contact@entrust-services.com](mailto:contact@entrust-services.com)  
 Phone : +353 (0) 91 342 511

Disclaimer : Information on this map is reproduced from digital and other material from different sources. Minor discrepancies may therefore occur. This plan should be used for identification purpose only, unless specifically stated above or in accompanying documentation. Entrust takes no responsibility for the accuracy of data provided by third parties.

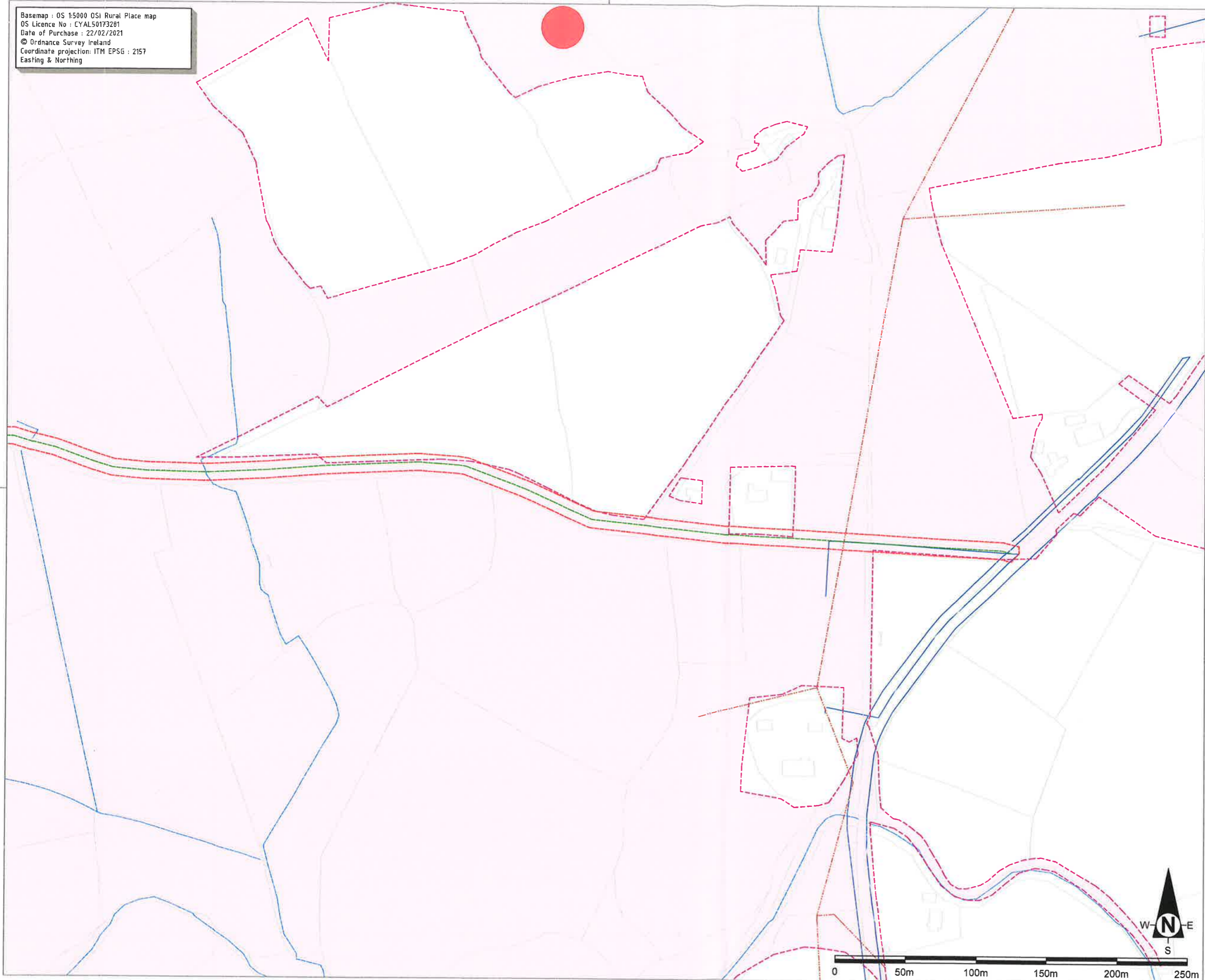

553000







554000

555000

**Caher Cross to Cloonagh Co. Clare  
Fibre Route augmentation**

**Site Designations Map**

**Legend**

-  Eir Fibre Route
-  SMRs
-  RPS
-  SMRs notification Zone
-  NHA
-  SPA
-  Scenic Route

Constraints: Data collected from heritage Ireland, buildings of Ireland  
 Basemap: Omniscale, Map data: OpenStreetMap (License: ODbL)  
 Projection: ITM, EPSG:2157  
 Disclaimer: Information on this map is reproduced from digital and other material from different sources. Minor discrepancies may therefore occur. This plan should be used for identification purpose only, unless specifically stated above or in accompanying documentation. Entrust takes no responsibility for the accuracy of data provided by third parties.

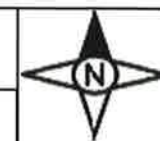

**Scale @A3:** 1:10,000

**Date:** 10/11/2021

**Revision:** V 1.0

**Created by:** Ignatius T.F. Lo

**Verified by:** Neil Gates

**Approved by:** Kieran Tarpey

**Contact Details:**



**Entrust Ltd.**  
 Unit 1D, Deerpark Business Centre  
 Oranmore  
 Co. Galway  
 T: 091 342 510  
 e: [contact@entrust-services.com](mailto:contact@entrust-services.com)  
 w: [www.entrust-services.com](http://www.entrust-services.com)

691000

690000

689000

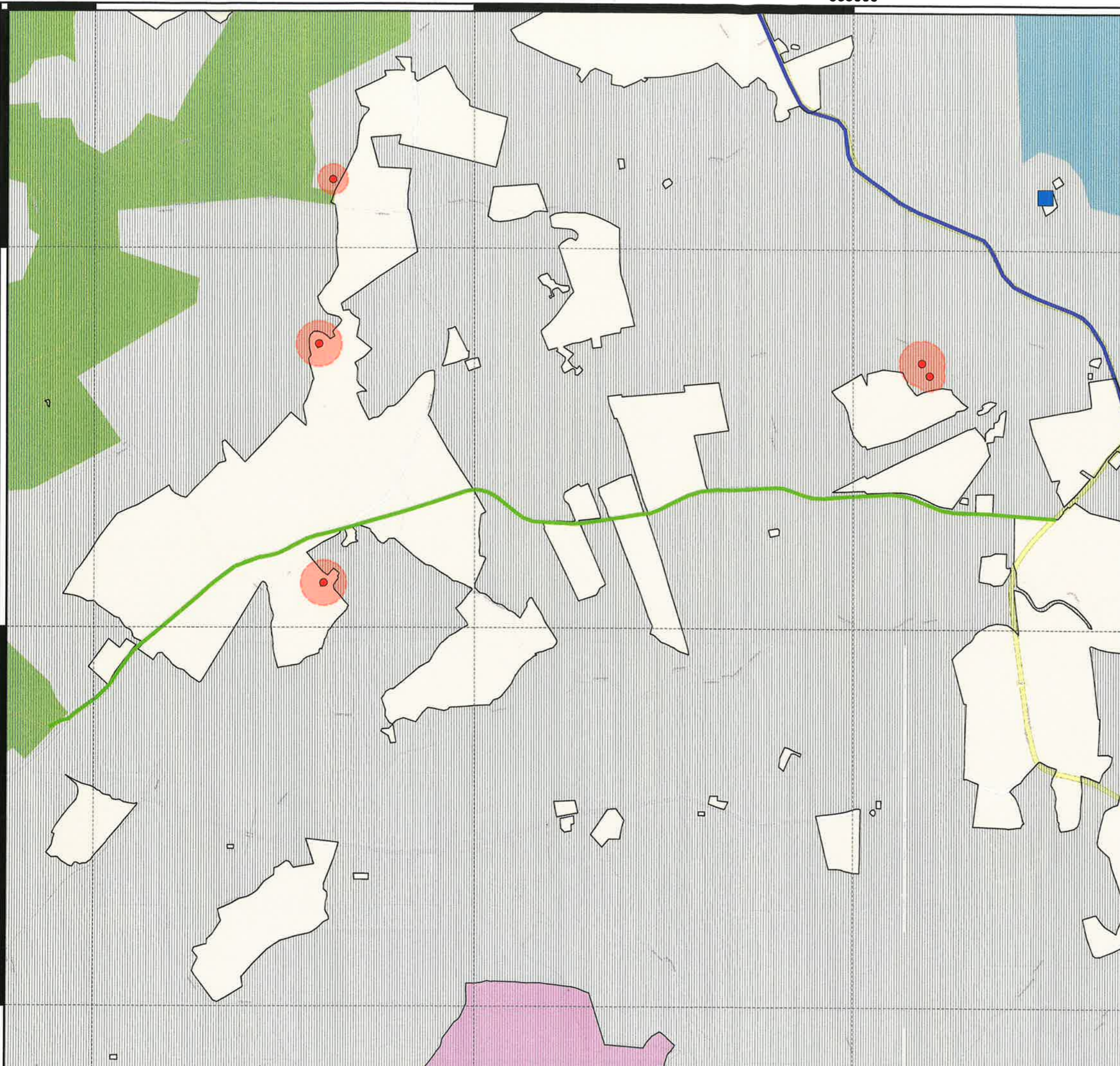

Clare County Council  
Aras Contae an Chláir  
New Road  
Ennis  
Co Clare



21/02/2022 11:34:59

Receipt No. L1CASH/0/328799

\*\*\*\*\* REPRINT \*\*\*\*\*

EIRCOM LTD  
C/O KIERAN TARPEY  
ENTRUST LTD  
UNIT 1D DEERPARK BUSINESS CENTRE  
ORANMORE  
CO GALWAY H91 KHN0  
R22-13

COMHAIRLE

SECTION 5 REFERENCES 80.00  
GOODS 80.00  
VAT Exempt/Non-vatable

Total : AN CHLÁIR 80.00 EUR

Tendered :  
CHEQUES



Change :

Issued By : L1CASH - Nolette Barry  
From : MAIN CASH OFFICE LODGEMENT AREA  
Vat reg No.0033043E