

CROSSMORE WINDFARM, CARROWREAGH WEST, CO. CLARE - DIVERSION ROUTES

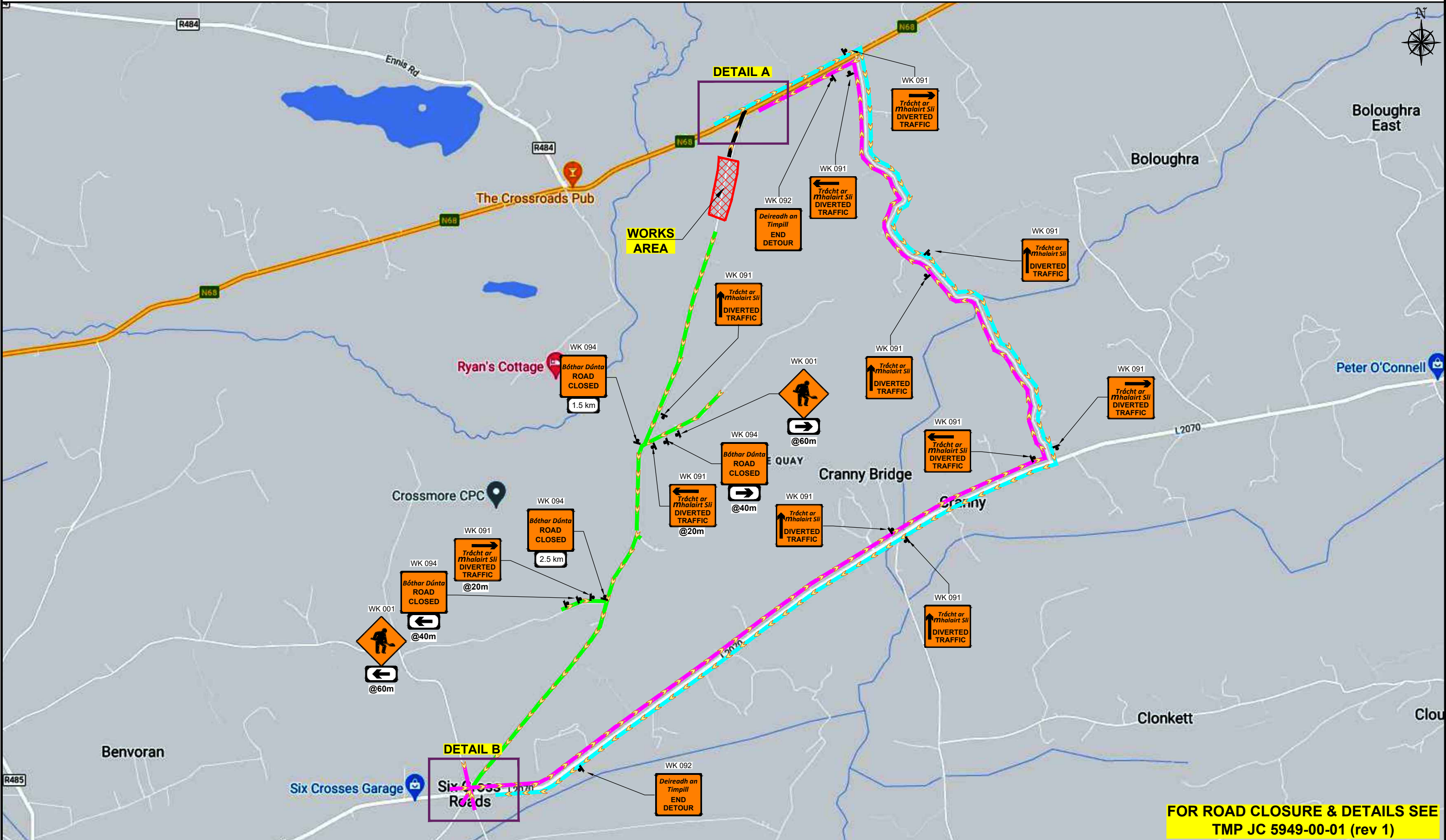

**FOR ROAD CLOSURE & DETAILS SEE
TMP JC 5949-00-01 (rev 1)**

DESIGN PARAMETERS				SAFETY ZONE			TEMPORARY SIGNS				CONE SPACING AND SIZE				RATE OF TAPER		LAMP SPACING		TRAFFIC MANAGEMENT SYSTEM		
Road Lvl(Sub)	Roadworks Type	Speed Limit (km/h)	Min. Lane Width (m)	Longitudinal (m)	Lateral (m)	Set Back (m)	Distance (m)	Number	Min. Size (mm)	Sign Visibility (m)	Longitudinal (m)	At Tapers (m)	Min. Height (mm)	Taper at H/ S (m)	Taper at Lane (m)	At Tapers (m)	Longitudinal (m)	Method	Coned Area Length (m)	Max. Traffic Flow (veh/h)	
1 (iv)	A	60	3.00	15	0.5	-	20	3	600	60	6	1	750	45°	45°	6	12	Diversion	n/a	n/a	
2 (j)	A	80	3.00	45	1.2	-	120	4	600	90	12	3	750	45°	45°	6	24	Diversion	n/a	n/a	

NOTES:	
1) ALL INFORMATION CONTAINED IN THIS DRAWING SHOULD BE CHECKED AND VERIFIED BY CONTRACTOR PRIOR TO ANY STAGE OF CONSTRUCTION.	4) CONTRACTOR SHALL BE RESPONSIBLE FOR THE PROVISION OF RAMP ACCESS AT ANY CHANGE IN ROAD SURFACE LEVEL WHERE TRAFFIC RUNS ON A TEMPORARY SURFACE.
2) ALL WORKS ARE TO BE CARRIED OUT IN ACCORDANCE WITH LOCAL AUTHORITY REQUIREMENTS AND ARE TO BE INCLUDED IN THE SITE-SPECIFIC SAFETY & HEALTH PLAN.	5) THIS TRAFFIC MANAGEMENT PLAN MAY ONLY BE IMPLEMENTED BY A TTOS WHO MUST CARRY OUT A RISK ASSESSMENT BEFORE IMPLEMENTATION. TTOS MUST BE IN POSSESSION OF CSCS CARD 'SIGNING, LIGHTNING AND GUARDING AT ROAD WORKS' CONSTRUCTION REGULATIONS 2006.
3) CONTRACTOR TO CARRY OUT A SITE RISK ASSESSMENT PRIOR TO THE INSTALLATION OF ANY TRAFFIC MANAGEMENT PLAN TO ENSURE THAT CONDITIONS REFLECT THOSE CONSIDERED FOR DESIGN POST SUBMISSION.	6) EXACT SIGNS POSITIONS TO BE AGREED ON SITE.
	7) ACCESS TO BE MAINTAINED TO ALL DWELLINGS / BUSINESSES AT ALL TIMES.
	8) SITE INSPECTIONS AND MAINTENANCE OF THE TRAFFIC MANAGEMENT LAYOUT IS TO BE CONDUCTED ON A DAILY BASIS TO ENSURE THE SAFETY AND INTEGRITY OF THE DESIGN.
	9) ALL TEMPORARY FOOTWAYS MUST HAVE A GOOD QUALITY, EVEN SURFACE AND BE MAINTAINED FREE FROM OBSTRUCTION.
	10) WHERE A SITE-SPECIFIC SURVEY HAS NOT BEEN CARRIED OUT BY GKTM LTD., THE COMPANY DOES NOT ACCEPT THE APPOINTMENT AS TM DESIGNER FOR THE PROJECT. ANY TTMLD PRODUCED BY GKTM LTD. IS FOR THE PRELIMINARY SAFETY PLAN ONLY AND MUST BE FURTHER DEVELOPED BY A TM DESIGNER APPOINTED BY THE MAIN CONTRACTOR FOR THE CONSTRUCTION PHASE.
	11) PEDESTRIANS TO BE PROTECTED FROM WORKS AREA BY PEDESTRIAN BARRIER SYSTEM.
	12) TM OPERATIVES TO MAINTAIN CLOSURE, MARSHAL PEDESTRIANS AND INFORM DRIVERS ABOUT DIVERSION ROUTES.
	13) DUE TO ROAD GEOMETRY, RISK ASSESSMENT AND THE OBSERVED SPEED OF VEHICLES ALONG THIS ROAD, THE DESIGN PARAMETERS HAVE BEEN CONSIDERED AS PER A 60km/h LEVEL 1(iv) ROAD FOR SOME SECTIONS.

LEGEND	
	- SIGN LOCATION
	- WORKS AREA
	- DIVERSION ROUTE
	- DIVERSION ROUTE
	- DIVERSION ROUTE
	- DIVERSION ROUTE

		GARY KEVILLE TRAFFIC MANAGEMENT LTD. Rosemount Business Park, Dublin 11, Co. Dublin, Ireland Tel: (+3531) 667 4322; Email: info@gktm.ie Visit us at: www.gktm.ie		CLIENT: CIVIL ENGINEERING CONTRACTORS	
DESIGNED: SS	SCALE: NTS	PROJECT TITLE: CROSSMORE WINDFARM, CARROWREAGH WEST, CO. CLARE			
DRAWN: SS	DATE: 12-07-2023	DRAWING NAME: DIVERSION ROUTES			
VERIFIED: BJ	DATE: 12-07-2023	STAGE: CONSTRUCTION		DWG. No.: JC 5949-00-01a	REV: 1
APPROVED: MA	DATE: 12-07-2023				
Rev. No.: 1		Revision Details: Amended/relocated works location		Rev. Date: 22-04-2024	Designed: SS
				Drawn: BJ	Verified: SS
				Approved: SS	Copyright Notes: THIS DRAWING IS THE PROPERTY OF GARY KEVILLE TRAFFIC MANAGEMENT. THE DESIGN INFORMATION CONTAINED HEREIN IS STRICTLY CONFIDENTIAL. THIS DOCUMENT IS NOT TO BE USED, REPRODUCED, DISCLOSED OR CIRCULATED IN WHOLE OR IN PART WITHOUT THE PRIOR WRITTEN CONSENT IN EACH INSTANCE OF GARY KEVILLE TRAFFIC MANAGEMENT. © GKTM 2024