

- NOTES:**
1. ALL DIMENSIONS ARE IN MILLIMETRES AND LEVELS IN METRES UNLESS NOTED OTHERWISE.
 2. USE FIGURED DIMENSIONS ONLY. DO NOT SCALE.
 3. DRAWINGS TO BE READ IN CONJUNCTION WITH ALL RELEVANT PROJECT BRIEFS, SPECIFICATIONS & PRICING DOCUMENTS.
 4. CONTRACTOR TO ALLOW FOR SITE SETUP, STORAGE COMPOUND & ALL ANCILLARY MEASURES NECESSARY TO CARRY OUT THE WORKS.
 5. CONTRACTOR TO UNDERTAKE ROLE OF PROJECT SUPERVISOR CONSTRUCTION STAGE (PSCS).
 6. CONTRACTOR TO MAINTAIN VEHICULAR THROUGH ACCESS ALONG ROAD AT ALL TIMES FOR THE DURATION OF THE WORKS.
 7. CONTRACTOR TO ALLOW FOR ALL TRAFFIC MANAGEMENT ARRANGEMENTS AND OBTAINING ROAD OPENING LICENSES AS NECESSARY.
 8. CONTRACTOR TO IDENTIFY & PROTECT ALL EXISTING SERVICES WITHIN THE WORKS AREA AT OUTSET OF WORKS.
 9. EXISTING DRAINAGE INFRASTRUCTURE HAS BEEN SHOWN BASED ON AVAILABLE TOPOGRAPHICAL & OTHER SURVEY INFORMATION.
 10. ALL WORKS TO BE CARRIED OUT IN ACCORDANCE WITH CURRENT BUILDING REGULATIONS.
 11. TACTILE PAVING TO BE INSTALLED IN ACCORDANCE WITH GUIDANCE ON THE USE OF TACTILE PAVING SURFACES DOCUMENT & TII STANDARD DETAIL CC-SCD-05536.
 12. KERBS, FOOTWAYS AND PAVED AREAS TO BE IN ACCORDANCE WITH TII PUBLICATIONS FOOTWAY DESIGN & VOLUME 1 SPECIFICATION FOR ROAD WORKS SERIES 1100 KERBS, FOOTWAYS AND PAVED AREAS.
 13. FOOTPATH REINSTATEMENTS OR FOOTPATH EXTENSIONS MUST MATCH EXISTING SURFACES.
 14. ALL SIGNAGE AND ROAD MARKINGS TO BE IN ACCORDANCE WITH THE TRAFFIC SIGNS MANUAL.
 15. REINSTATE ROAD MARKINGS TO ALSO BE IN ACCORDANCE WITH IS EN 1436 EUROPEAN STANDARD FOR ROAD MARKINGS.
 16. REMOVE AND RELOCATE STOP/ YIELD ROAD MARKINGS WHERE NECESSARY.
 17. REMOVE AND RELOCATE LINE MARKINGS WHERE NECESSARY.
 18. ALL NEW / REPLACEMENT MANHOLE COVERS & GULLEY GRATES TO LOADING CLASS D400.
 19. CONTRACTOR TO ALLOW FOR CONNECTION OF ALL EXISTING & NEW ROAD GULLEYS TO EXISTING SURFACE WATER DRAINAGE PIPEWORK.
 20. CONTRACTOR TO ALLOW FOR ALTERATIONS TO EXISTING BOUNDARY BOXES, WATER METERS, HYDRANTS, SLUICE VALVES & SCOUR VALVES WITHIN WORKS AREA.
 21. JOINTS TO BE PROVIDED IN CONCRETE FOOTPATHS TO ACCOMMODATE HORIZONTAL MOVEMENT DUE TO CHANGES IN TEMPERATURE & MOISTURE CONTENT.
 22. ON COMPLETION, CONTRACTOR TO ALLOW FOR MAKING GOOD TO ALL AREAS AFFECTED BY THE WORKS.

Revision	Description of Changes made	By	Date

CLARE COUNTY COUNCIL

Road Design Office, Áras Contae an Chláir, New Road, Ennis, Co. Clare
 T: 065 6821616 F: 065 68 21915
 E: rdo@clarecoco.ie W: www.clarecoco.ie

Project Title: **Connecting & Co- Creating Ennis**

Drawing Title: **Uncontrolled Crossings - At Junctions of Carmoy St with Summerhill & Buttermarket Rd**

Status:	TENDER	Drawing No.:	Rev:
Designed by:	JB	R.2022.70.09.23.051	-
Drawn by:	JB		
Checked by:	Cmc	Location:	
Approved by:	Cmc	Scale:	1:200 @ A3
Date:	20/09/2022		

© THIS DRAWING AND ANY DESIGN HEREON IS THE COPYRIGHT OF CLARE COUNTY COUNCIL AND MAY NOT BE COPIED, REPRODUCED OR TRANSMITTED IN ANY FORM WITHOUT THE PRIOR WRITTEN CONSENT OF THE CLARE COUNTY COUNCIL. ALL DIMENSIONS TO BE CHECKED ON SITE AND ANY DISCREPANCIES TO BE REPORTED TO THE CLARE COUNTY COUNCIL BEFORE WORK PROCEEDS. INCLUDES DRAINAGE SURVEY IRELAND DATA REPRODUCED UNDER DES LICENSE NUMBER 0810109.004.001/CLARE COUNTY COUNCIL. UNAUTHORISED REPRODUCTION IMPROVES DRAINAGE SURVEY IRELAND AND GOVERNMENT OF IRELAND COPYRIGHT. COPYRIGHT © DRAINAGE SURVEY IRELAND 2012.

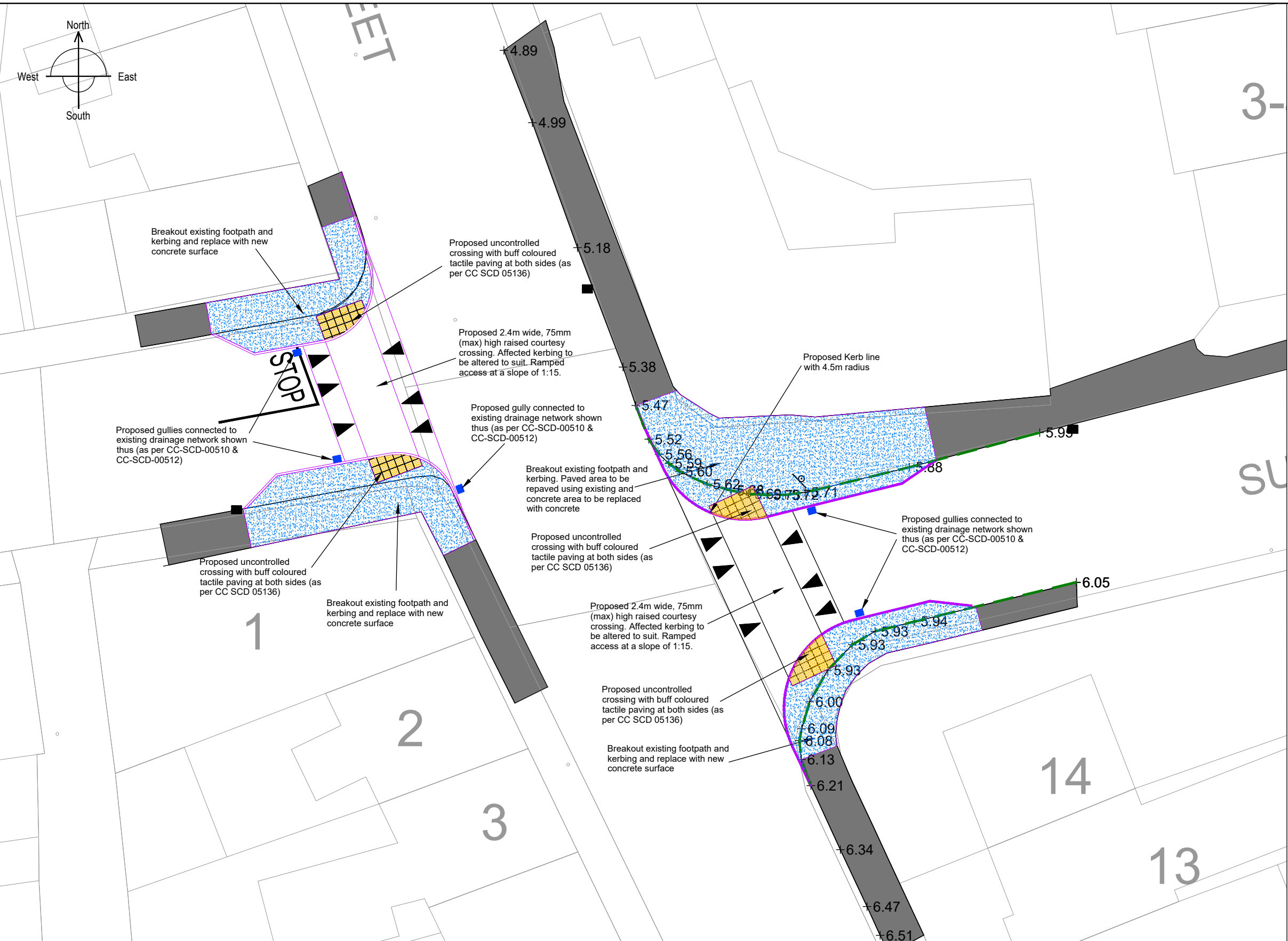

Legend:

	Proposed Ramp		Proposed Road Gully
	Existing Footpath - Bitumen		Existing Road Gully to be retired
	Existing Footpath - Concrete		Existing Road Gully to be kept
	Proposed buff tactile paving at uncontrolled crossing		Proposed Kerbing
	Existing Area to Remove		Proposed Dropped Kerb
	Existing Footpath / Tactile		Proposed Ramp
	Proposed Footpath		Existing Spot Height Road Level
	Proposed Grass Area		Existing Grass Area